

# MOUNTING PARTS



**A** - (1 pcs)



**B** - (1 pcs)



**C** - (8 pcs)

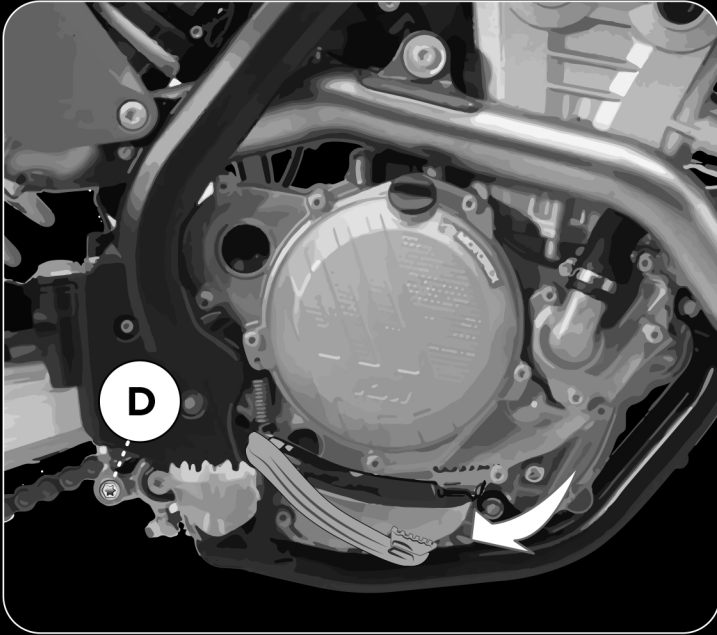

**To mount the X-Power, begin by unscrewing the D bolt and lowering the rear brake pedal.**

Per facilitare il montaggio del X-Power svitare la vite D del pedale e abbassarlo.

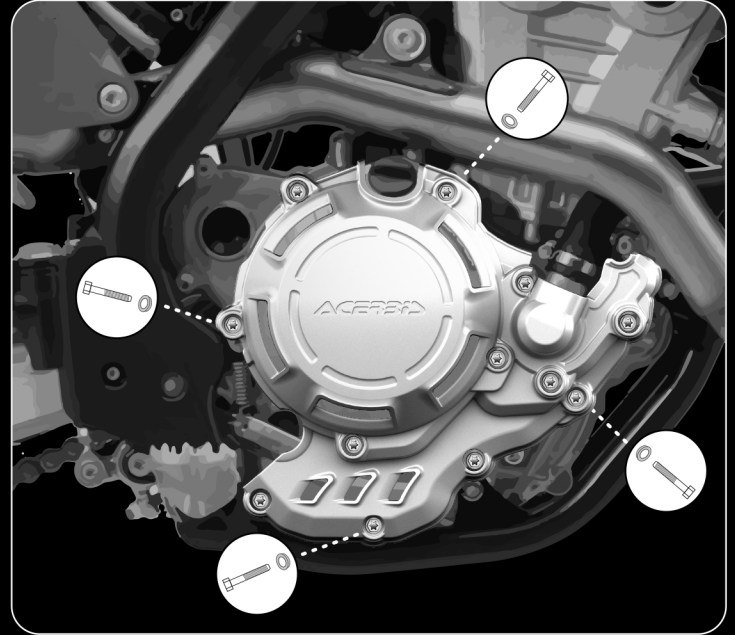

**Remove 4 OEM clutch cover bolts exactly as indicated in the image above. Attach the X-Power clutch cover utilizing the 4 OEM bolts and 4 of the included C bushings and then tighten to the manufacturers suggested torque settings as indicated in the owners manual. Re-install the rear brake bolt D. And tighten them to the manufacturers suggested torque settings.**

Rimuovere le 4 viti originali indicate in figura. Montare la protezione frizione X-Power con le viti originali e le 4 boccole C. Riposizionare il pedale, e riavvitare le viti D. Coppia di chiusura come riportato su manuale moto.

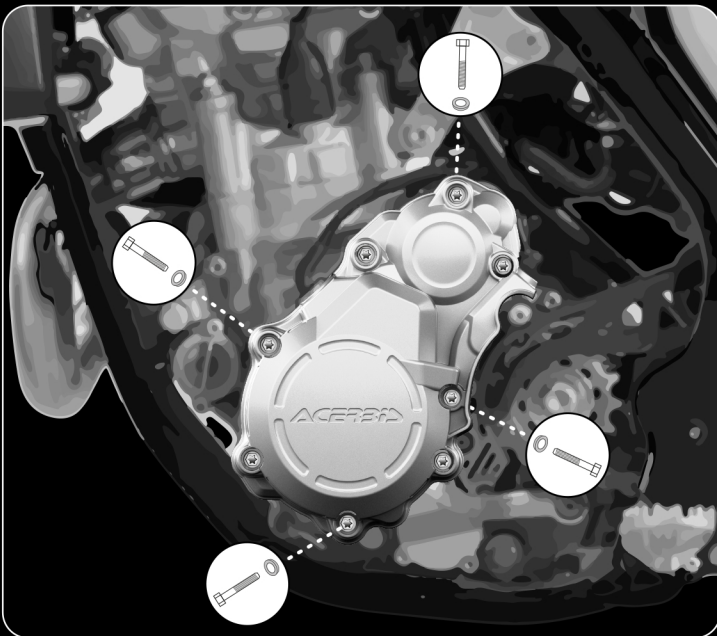

**Remove 4 OEM ignition cover bolts exactly as indicated in the image above. Attach the X-Power ignition cover with the remaining 4 C bushings and the 3 stock ignition cover bolts and tighten to the OEM torque settings in the owners manual.**

Rimuovere le 4 viti originali indicate in figura. Montare la protezione accensione X-Power con le viti originali e le 4 boccole C. Coppia di chiusura come riportato su manuale moto.